

The „Ready-to-go“ Lysimeter is a small lysimeter station for soil columns with a surface area of up to 0.5 m<sup>2</sup> and a length of up to 0.9 m that can be filled by hand or be cut by UGT staff (undisturbed soil monolith).

It comprises a compact PE-HD lysimeter station with integrated weighing system and seepage water reservoir with tipping counter, a PE-HD lysimeter vessel, a data logger and a set of soil hydrological sensors.

You can choose between different extensions for the control station:

- modul extension with climate sensors
- modul extension for lower boundary system

Everything is prepared to work as plug and play system so that the complete station can be set up and put into operation without any special staff or tools. The data can be displayed and read out on any PC that is connected to the internet using a data bank system and a server.



# Ready-To-Go Lysimeter Components

length	dia- meter		
	Ø 300	Ø 500	Ø 800
300	180201	180203	180211
600	180200	180204	180210
900	180202	180205	180212

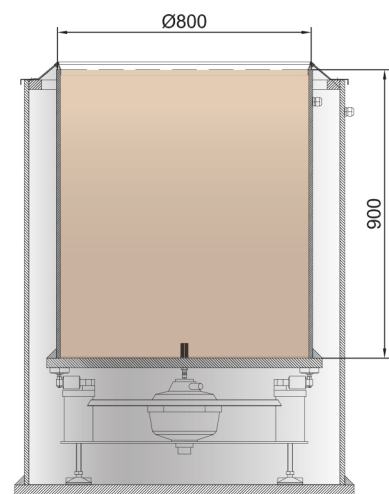
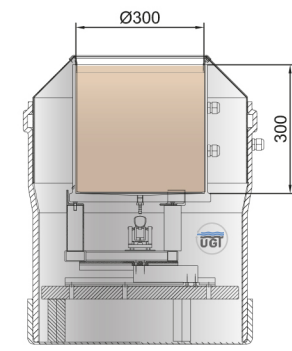

①.

## Sizes of Ready-To-Go Lysimeters

- per size consisting of:
- Lysimeter PE-HD outer vessel
  - Stainless steel lysimeter vessel for soil columns
  - Lysimeter collar
  - Load triangle
- Sensors:**
- Special weighing system
  - 3 soil moisture temperature probes SMT-100
  - 3 FRT Fullrange tensiometers



Manual excavation



Excavation undisturbed soil monoliths excavation equipment BASIC  
Ø 300 mm 180260  
Ø 500 / Ø 800mm 180261



Excavation undisturbed soil monoliths  
Extended service UGT GmbH

②.

## Excavation

- Manual
- Basic
- Extended service UGT GmbH



RTG-Control Station 180222

③.

## RTG-Control Station

- consisting of:
- Datalogger
  - Solar panel
  - Software, incl. project creation
  - Mast for attaching the data logger, solar panels and sensors
  - Battery



Control station with climate sensors 180220

opt.

## Control station with climate sensors

- consisting of:
- Rain gauge
  - Temperature and humidity sensor with protection hut
  - Soil temperature sensor
  - Global radiation sensor



Lower boundary system 180221

opt.

## Lower boundary system

- consisting of:
- Tensions- and Timed suction probes conditioning
  - Reference sensor
  - Compensating cylinder to add water

## Suction cup ring

- consisting of:
- 5 porous ceramic tubes for Ø 300 mm
  - 8 porous ceramic tubes for Ø 500/800 mm

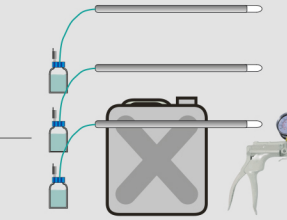

Pore water sampling (manuel use) in three depths 180300

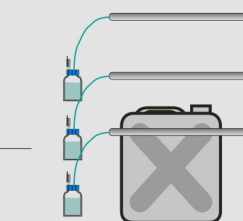

Pore water sampling (Lysimeter-SSA) in three depths 180301 in combination with

opt.

## Pore water sampling

- manuel pore water sampling with hand pump
- automatic pump with tension control

opt.

## Online Data Service

SVADSS offers a unique online data management system for your measuring systems, customized for your need. To view various examples, please visit our website [www.svadss.net](http://www.svadss.net)

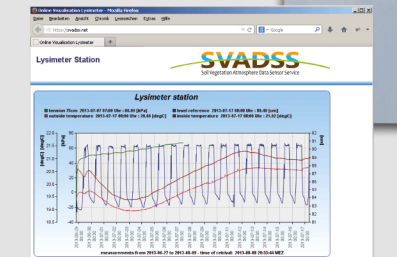

SVADSS-SF  
Set up fee 216001

SVADSS-RTG 1  
basic fee for 1 year 216036

SVADSS-RTG 2  
basic fee for 2 years 216037

SVADSS-RTG 5  
basic fee for 5 years 216038